

TYPICAL DRAWING

Art. BT200

Trunnion mounted Ball Valve/
side-entry/DB&B/single ball/
pin trunnion

DIFFERENT SIZES,
PRESSURE CLASSES AND
MATERIALS ARE AVAILABLE AS PER
OUR QUOTATION

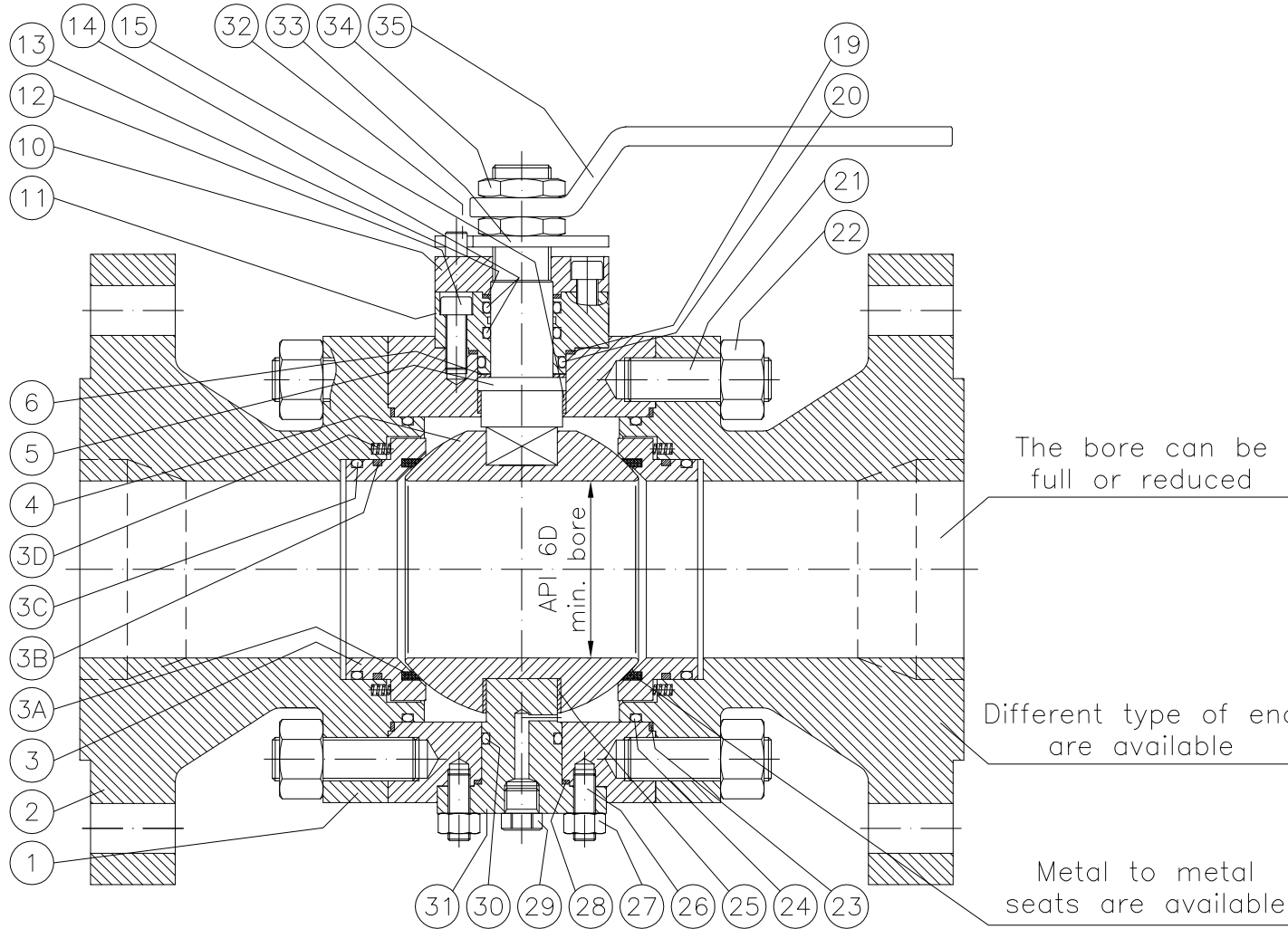

BILL OF MATERIAL

POS.	PART NAME	MATERIAL	NOTE
35	LEVER		
34	NUT		
33	STOP SECTOR		
32	STOP PIN		
31	TRUNNION		
30	O-RING		
29	DRAIN PLUG		
28	GASKET		
27	NUT		
26	STUD		
25	SHELL BEARING		
24	O-RING		
23	GASKET		
22	NUT		
21	STUD		
20	O-RING		
19	GASKET		
18	GREASE INJECTOR		
15	SHELL BEARING		
14	O-RING		
13	GASKET		
12	FLANGE SCREW		
11	GLAND		
10	OPERATOR FLANGE		
7	/		
6	THRUST WASHER		
5	STEM		
4	BALL		
3D	SPRING		
3C	O-RING		
3B	GASKET		
3A	SEAT		
3	SEAT RING		
2	BODY END		
1	BODY		

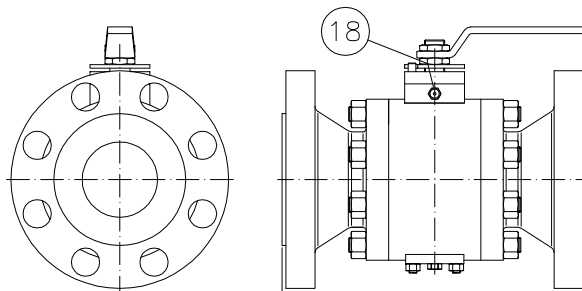

API6D/ASME B16.10

Fire safe construction



Denomination:
TRUNNION BALL VALVE Art. BT200
Lever operated - Full bore
Standard construction

Drawing:
BT200ST-L-F

Rev.:
00